

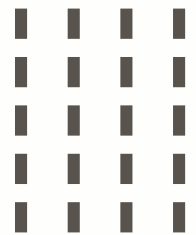

Recessed Hinges and Profile



www.ectratech.com

@ectratech



Recessed Soft Close Hinges 20kg

RECESSED HINGE AND PROFILE



FRONT ADJUSTMENT:
+2mm / -0,5mm

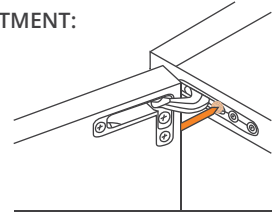
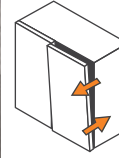

LATERAL ADJUSTMENT:
+2mm / -2mm

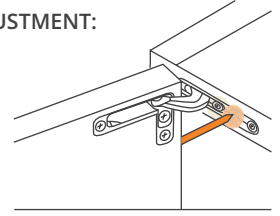
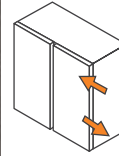

VERTICAL ADJUSTMENT:
+1,5mm / -1,5mm

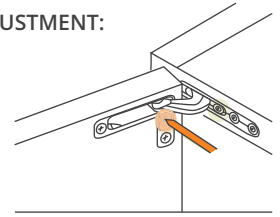
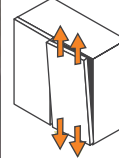

DOOR PROJECTION

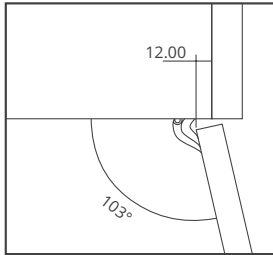

$A = (17+D) - S$

Space Required for Door Opening

	DOOR THICKNESS (MM)							
	18	20	22	24	26	28	30	32
D3	0.0	0.2	0.5	0.9	1.4	2.1	3.1	4.7
D4	0.0	0.2	0.5	0.9	1.4	2.0	2.9	4.2
D5	0.0	0.2	0.5	0.8	1.3	2.0	2.8	3.9
D6	0.0	0.2	0.5	0.8	1.3	1.9	2.7	3.7

The space required can be reduced according to the radius of door edges.

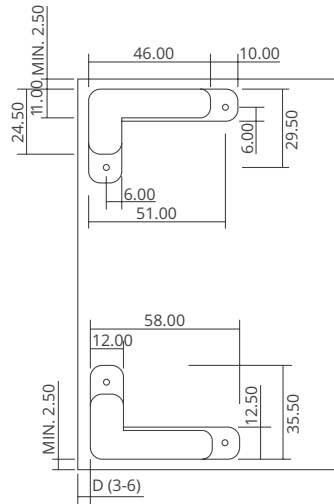
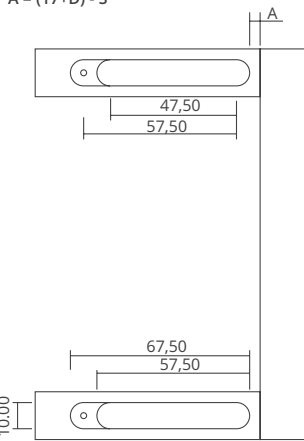
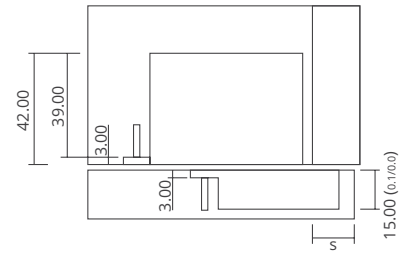

HINGES



Black

Nickel

COVER CAPS

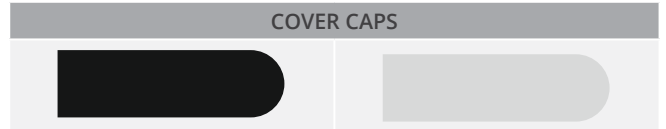

Black

Grey

Material : Zamak and Steel

Invisible Recessed Hinges

Soft Close (ZHAFHH148001001/002/004/005), *Push to Open (ZHAFHH148005001/002/004/005) Unit : mm

CODE	DOOR			MIN. THICKNESS OF PANEL	OPENING ANGEL	TYPE	FINISH
	MAX. HEIGHT	MAX. WIDTH	MAX. WEIGHT				
ZHAFHH148001001	2000	600	20kg	18	105°	Right	Black
ZHAFHH148001002	2000	600	20kg	18	105°	Left	Black
ZHAFHH148001004	2000	600	20kg	18	105°	Right	Nickel
ZHAFHH148001005	2000	600	20kg	18	105°	Left	Nickel
ZHAFHH148005001*	2000	600	20kg	18	105°	Right	Black
ZHAFHH148005002*	2000	600	20kg	18	105°	Left	Black
ZHAFHH148005004*	2000	600	20kg	18	105°	Right	Nickel
ZHAFHH148005005*	2000	600	20kg	18	105°	Left	Nickel

Data not binding. We reserve the right to alter specifications without notice.

Recessed Soft Close Hinges 30kg

RECESSED HINGE AND PROFILE



FRONT ADJUSTMENT:
+2mm / -0.5mm

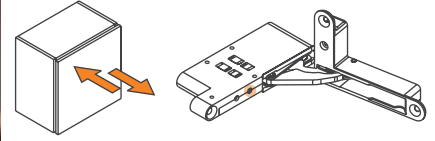

LATERAL ADJUSTMENT:
+2mm / -2mm

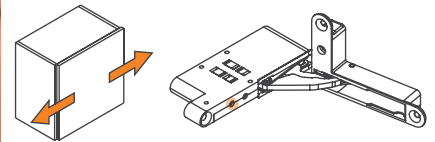

VERTICAL ADJUSTMENT:
+2mm / -2mm

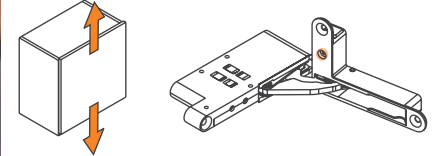

_milling on top and bottom panels

$$A = (22.5 + D) - S$$

$$Y = (X - W) - 1$$

$$W = (X - Y) - 1$$

$$X = (W + Y) + 1$$

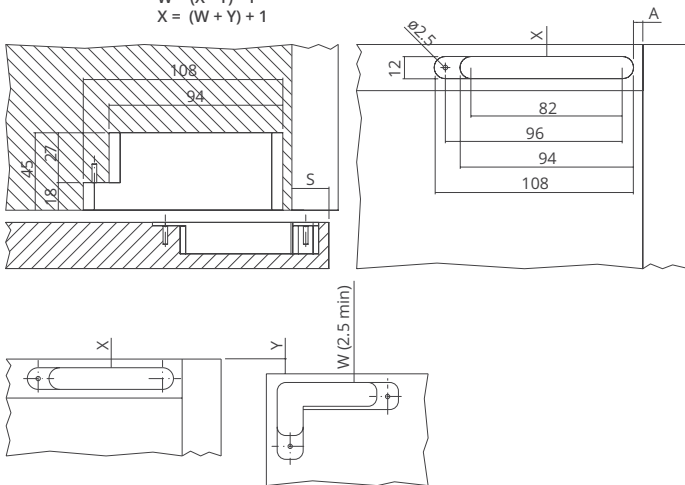

_milling on wooden door

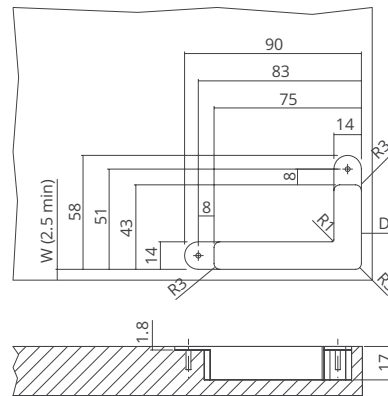

HINGES

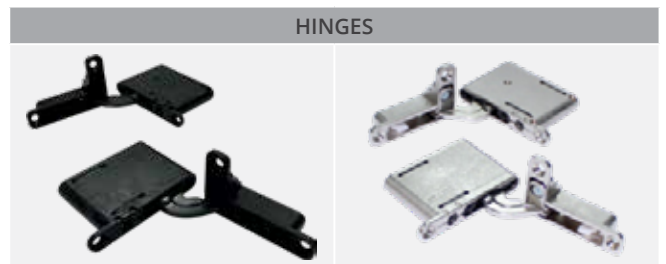

Black

Nickel

Material : Zamak and Steel

Invisible Recessed Hinges

Unit : mm

CODE	MIN. THICKNESS OF TOP/BOTTOM	DOOR THICKNESS	OPENING ANGEL	MAX. WEIGHT	TYPE	FINISH
ZHAFHH165001003	18mm	20-40mm	100°	30kg	Right	Black
ZHAFHH165001004	18mm	20-40mm	100°	30kg	Left	Black
ZHAFHH165001001	18mm	20-40mm	100°	30kg	Right	Nickel
ZHAFHH165001002	18mm	20-40mm	100°	30kg	Left	Nickel

Data not binding. We reserve the right to alter specifications without notice.

Aluminium Profiles for Glass Door Application

RECESSED HINGE AND PROFILE

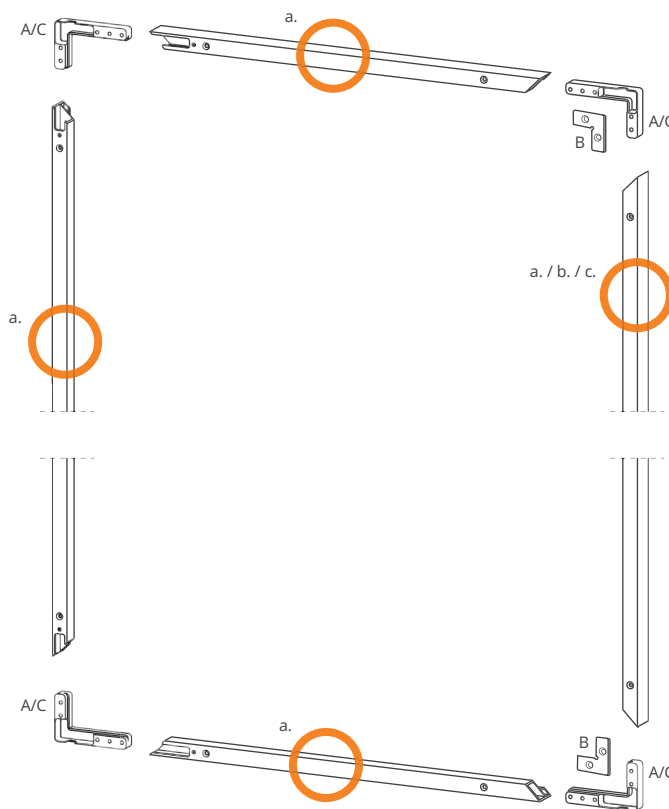

TYPE - a

TYPE - b

TYPE - c

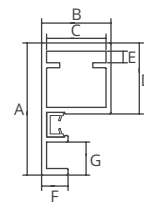
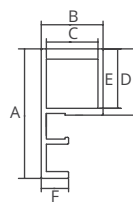
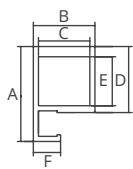

Aluminium Profile

Unit : mm

CODE	A	B	C	D	E	F	G	LENGTH	LOAD CAPACITY	TYPE	FINISH
ZHAFHH148003002	27.9	18.1	15.1	19.4	14.4	8	-	3000	20kg	a / a + b	Brown Metal Grey
ZHAFHH148009002	37.9	18.1	15.1	19.4	14.4	8	-	3000	20kg	a / a + b	Brown Metal Grey
ZHAFHH165004001	30	21	18	21.5	17	8	-	3000	30kg	a / a + c	Brown Metal Grey
ZHAFHH165003001	40	21	18	21.5	3.5	8	10	3000	30kg	a / a + c	Brown Metal Grey

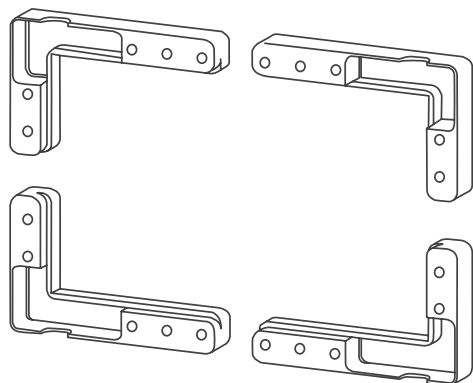

Brackets for 20kg Profiles (Type : A)

CODE	DESCRIPTION
ZHAFHH148002001	Brackets for Alu.profile (2xRH+2xLH)

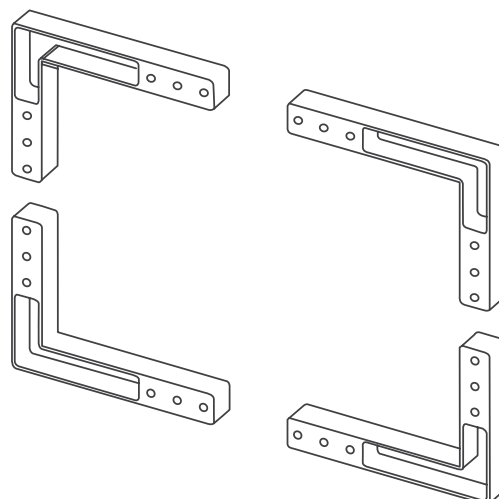

Brackets for 30kg Profiles (Type : C)

CODE	DESCRIPTION
ZHAFHH165002004	Brackets for Alu.profile (2XRH-BIG+2XLH-BIG)

Data not binding. We reserve the right to alter specifications without notice.

Aluminium Door Profiles

Made In Italy

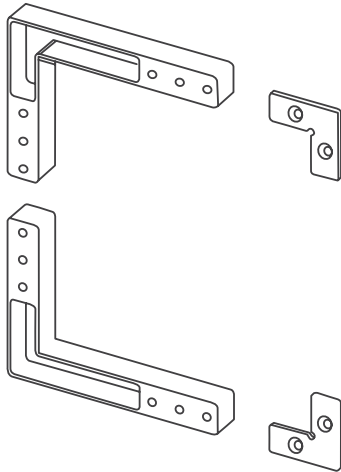

Brackets for 30kg Profiles (Type : B)

CODE	DESCRIPTION
ZHAFHH165002005	Brackets for Alu.profile (1XRH/LH-BIG+1XRH/LH-SMALL)

Made In Italy



Rubber Seal

Unit : mm

CODE	THICKNESS	LENGTH	FINISH
ZHAFHP011010001	4	3000	Transparent

Made In Italy

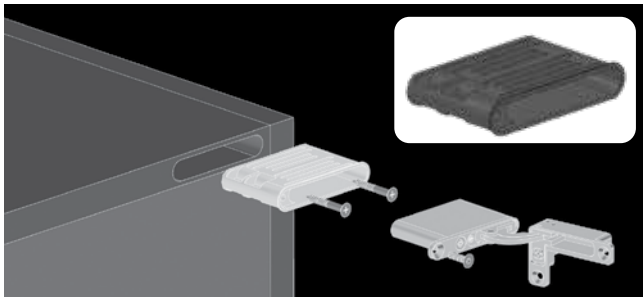

Housing Case (Optional)

CODE	DESCRIPTION
ZHAFHH148010001	Housing Case for Hinge 20kg with Black Finish
ZHAFHH148010002	Housing Case for Hinge 20kg with Nickel Finish

Made In Italy



Fixing Support (Optional)

CODE	DESCRIPTION
ZHAFHH165005001	Fixing Support RH+LH with Screws for Hinge 30kg.

Made In Italy

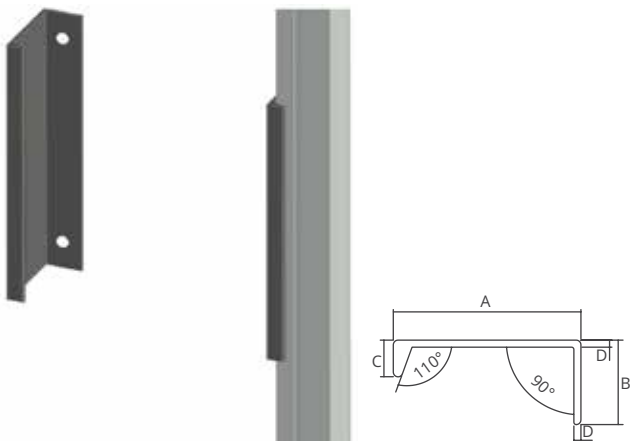

Aluminium Handle for Hinge 30kg and 20kg

Unit : mm

CODE	A	B	C	D	LENGTH	FINISH
ZHAFHH148008002	40	18	7.8	1.5	120	Brown Metal Grey

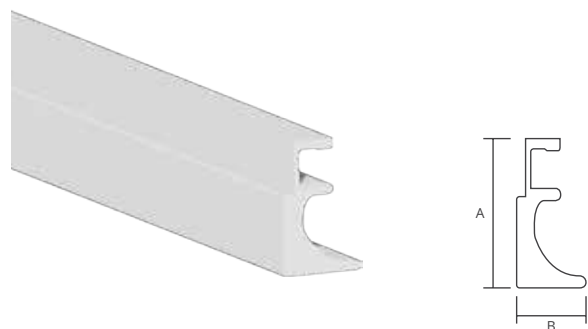

Aluminium Handle

Unit : mm

CODE	A	B	LENGTH	FINISH
BLNC261210M	22.75	12	1000	Mill Finish

Data not binding. We reserve the right to alter specifications without notice.

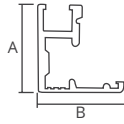
TYPE - 1
Glass Frame Aluminium Profile

Unit : mm/meter

CODE	A	B	LENGTH	FINISH
BLS9230723	23	21	3 meter	-
BLS9230723MBL	23	21	3 meter	Matt Black

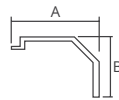
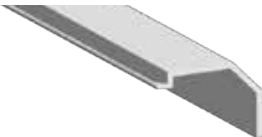
PVC Cover Profile

Unit : mm/meter

CODE	A	B	LENGTH	FINISH
BLS65003030	18	13	3 meter	-
BLS65003030MBL	18	13	3 meter	Matt Black

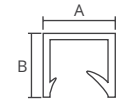
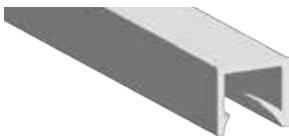
Rattle Protector Clear

Unit : mm/meter

CODE	A	B	LENGTH	FINISH
BLS65002130	7	5	3 meter	Clear
BLS65002130MBL	7	5	3 meter	Matt Black

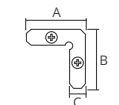
Corner Connectors (4pcs. Set)

Unit : mm/meter

CODE	A	B	C	LENGTH	FINISH
BLS923334	35	35	13	3 meter	-

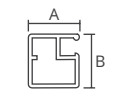
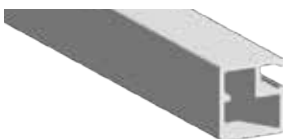
TYPE - 2
Aluminium Door Profile

Unit : mm/meter

CODE	A	B	LENGTH	FINISH
BLNDP912	20	21	3 meter	-

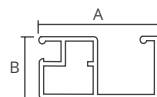
Aluminium Door & Handle Profile

Unit : mm/meter

CODE	A	B	LENGTH	FINISH
BLNDP9H12	41	20	3 meter	-

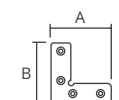
Steel "L" Bracket

Unit : mm

CODE	A	B	THICKNESS	FINISH
BLNLB45	44	44	2	-

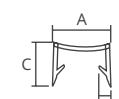
White Gasket

Unit : mm/meter

CODE	A	B	C	LENGTH	FINISH
BLNR613	6	1	5	cut to size	White



TYPE - 3

Rattle Protector Clear

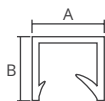
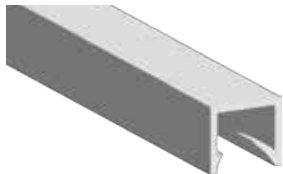

Unit : mm/meter

CODE	A	B	LENGTH	FINISH
BLS65002130	7	5	3 meter	Clear
BLS65002130MBL	7	5	3 meter	Matt Black

Aluminium Profile and Handle

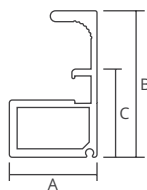

Unit : mm/meter

CODE	A	B	C	LENGTH	FINISH
BLNC2222HGB	22.5	37.7	22.7	3 meter	Brownish Gold
BLNC2222HMB	22.5	37.7	22.7	3 meter	Matt Black
BLNC2222HSG	22.5	37.7	22.7	3 meter	Satin Gold
BLNC2222HSL	22.5	37.7	22.7	3 meter	Silver

Aluminium Profile

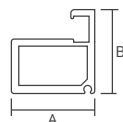

Unit : mm/meter

CODE	A	B	LENGTH	FINISH
BLNC2222BG	22.5	22.5	3 meter	Brownish Gold
BLNC2222MB	22.5	22.5	3 meter	Matt Black
BLNC2222SG	22.5	22.5	3 meter	Satin Gold
BLNC2222SL	22.5	22.5	3 meter	Silver

Silicon Bumper for BLNC Profiler



Unit : mm

CODE	A	B	C	FINISH
BLNC2222ZSC	3.10	3.30	2	Clear
BLNC2222ZSB	3.10	3.30	2	Black
BLNC2222ZSY	3.10	3.30	2	Yellow

Steel L Bracket

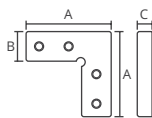

Unit : mm/meter

CODE	A	B	C	THICKNESS	FINISH
BLNC2222ZB	44.70	15.50	9.66	1.25	Steel



E-mail Address : info@uhsgulf.com, Website: www.ectratech.com
E-mail Address : info@uhsoman.com, Website: www.uhsoman.com

@ectratech

